

GUARANTEES:

In line with all other manufacturers of physical field water conditioners we give a full 100 day money back guarantee. Just take LP back to where you got it from with proof of purchase and you will be refunded in full.

FIVE YEAR MANUFACTURERS WARRANTY:

LPs are made to an exacting ISO 9002 standard, but as, human beings are involved things can go wrong, so if it does, return it for a replacement.

SPECIFICATION SOLO:

FOUR FRESH ALKALINED- CELLS

Consumption under 2mA

LEDs flash every 25 seconds

Output wave is square

2KHz to 45KHz every 100ms

Output Voltage 11v (peak to peak)

Battery check every 25 seconds

The Little Plumber range of water treatment products have been assembled with one overriding aim:

“To provide the very best products at affordable prices.”

The Little Plumber units fit into this ethos perfectly, representing excellent value for money without compromise. The LP1 and the larger LP2 Scale-Busters incorporate the finest features from the best existing units and combine these into a unique and compact product. They have been skillfully designed to be the best and if you find another unit with a similar specification be prepared to pay about twice the price.

The complete domestic water filtration system

Treat yourself to bottled quality water on tap with one of these superb units, they are easy to install, inexpensive to run, and are delivered within 24 hours.

*We are able to combine quality and low cost because of our years of experience in this business and a determination to be the best. **Do not tolerate sky high prices for these products, there is no need.** All of our units are guaranteed to give years of excellent service, and if you have any problems or questions please call us immediately on 01235 862540.*



splendid products ltd

Wythe, Church Street, East Hendred
Wantage, OX12 8LA
Tel: 01235 862540 Fax: 01235 862541
www.littleplumber.com
Email: sales@littleplumber.com



Solo LP Installation Instructions

Please read these instructions carefully before attempting installation - if you have any problems please call 01235 862540

You should have received:

- 1 x SOLO LP1 + 2 Aerials
- 6 x Cable Ties
- 2 x Wall plugs
- 2 x Screws

YOU WILL ALSO NEED

4 X 'D' CELLS and these should be ALKALINE CELLS.

Your new SOLO is manufactured to a very high standard and will provide you with years of excellent service if it is installed correctly. Please therefore take time to read these installation instructions carefully.

Firstly, you must determine whether your plumbing system is vented or unvented. Vented systems have a cold water storage tank, normally in the loft (you may also have a smaller tank to top up the central heating system but this is entirely separate). Unvented systems have no header tanks and water is heated at mains pressure.

Vented systems (with cold water storage tank) -

You will need to fit one model SOLO on the rising main near the stop-cock. Remember, the SOLO treats water upstream and downstream from the rising main up to the header tank. This means that you can fit the unit anywhere between the two, if you cannot get to the stop-cock. A good place would be in the airing cupboard if you can find the cold riser there. The aerials can be wrapped around any pipe except lead, a lead pipe will not be penetrated by the output signal. If you have a lead pipe then you will need a plumber to insert a section of copper for you, and you can then wrap the aerials around this.

OPTIONAL TREATMENT OF HOT WATER

CYLINDER:

To provide complete protection for your hot water cylinder you should install an additional SOLO on the cold down service between the header tank and the hot water cylinder. This is because the header tank breaks the continuity of the signal generated by the unit installed on the cold riser.

Unvented Systems (with no cold water storage tank) -

These will generally require only 1 SOLO unit on the rising main, again a larger property of 5 bedrooms. Combination boilers and heat stores will get dedicated protection if an additional SOLO is fitted on the cold supply, within 1.5 metres of the appliance.

INSTALLATION

Decide exactly where the unit or units are to be installed, ensuring that once the aerial wires are secured to the pipe that there is enough spare wire left to plug the ends into the sockets. You will need at least 10 aerial turns for each aerial for best effect. Simply wind the aerials around the pipe which is being treated and secure both ends with a cable tie, as shown in the diagram. Any spare

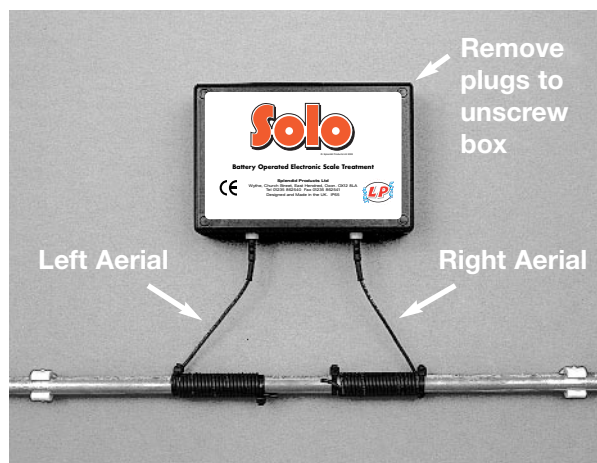

aerial left over can be wrapped back over the first windings if you are short of space. The closer the unit is installed to the pipe the better.

IT'S SO EASY TO FIT YOUR SOLO

Because your SOLO requires no plumbing or mains wiring it really is easy to install. Simply remove the front of the SOLO by unscrewing the two halves. In the case of the SOLO you will find 2 keyholes in the back of the rear panel and these can be slotted over two wall-mounted screws. To get the right position for these screws simply mark the keyhole outline with a pencil onto the surface you wish to mount the unit. In the case of the DE LUX SOLO you will find that the unit is completely sealed so fix with 4 screws, one through each corner. If your SOLO does not have the "keyholes" for screw attachment and later models do not, then simply affix the unit using two sided VELCRO.

OPERATION

To start your SOLO & SOLO De Lux you will now need to insert 4 x "D" alkaline batteries. The better the quality, the longer the unit will run. (Duracel are excellent). Replace the front panel. The LED will flash every 25 seconds as long as the battery is working.

SOFT WATER BENEFITS ALL ROUND THE HOUSE! WITH LITTLE PLUMBER ALL READY TO GO:

It has been reported by the U.S. government that consumers save a MINIMUM of 48% on their energy costs with the elimination of 3/8 of an inch of limescale build up. So a family of four can save over £400 a year with the removal of costly pipe clogging limescale.

What will I notice?

- i) Removal of scale and stains in showers, baths & basins
- ii) Softer smoother skin from treated water
- iii) Better tasting, less smelly water (for really great tasting tap water fit a Little Plumber water filter).
- iv) Disappearances of dry skin, eczema & psoriasis have been reported.
- v) Increased hot water pressure.
- vi) Softer, silkier hair.
- vii) Cleaner clothes after washing and less powder use.

All this without chemicals or the removal of essential minerals in your drinking water.

ANY PROBLEMS?

Well the Little Plumber SOLO doesn't work overnight, it can take up to six weeks for you to experience all the benefits listed above, so be patient. Sometimes there's a lot of scale to gradually disperse from your pipes, but once that's all gone you will be enjoying all the benefits of softer water that still retains all the healthy minerals you need like calcium- Good for Bones! Teeth!- Good for growing kids!!

NOTHING ELSE TO DO?

That's it - fit & forget and as long as the SOLO is winking... SOLO is working for one whole year.